



Skylarks Access Statement

Pre-Arrival

- Bookings can be made online via the website or by phone or email.
- Directions to the property can be found in the 'Touch Stay' app, sent to you before your stay.
- The accommodation is located on the first floor, accessed up a single flight of stairs from the street entrance.
- You can view the floor plans of the property in this statement and in the 'Touch Stay' app.
- The nearest train station is Haverfordwest, served by trains from Cardiff Central Station and Swansea. There are taxis at the station awaiting all train service arrivals and there is a limited bus service to St Davids.
- The nearest bus stop is in St Davids centre, approximately 50m from the cottage. More information on bus times can be found at <https://bustimes.org/localities/st-davids-pembrokeshire>
- If you require the statement information, directions or other details in a different format, please contact us via our website, e-mail, or telephone.
- Delivery of provisions can be arranged by using one of the large supermarket chains and the local St Davids Peninsula Producers Food Hub, who offer a delivery service of locally produced food. <https://openfoodnetwork.org.uk/peninsula-producers-food-hub/shop>
- The cottage may only be suitable for guests who have a visual, hearing or mobility impairment if they are accompanied. Emergency warning systems only provide audible warnings.

Key Collection, Car Parking & Communications

- You can off load in front of the apartment. There is free street parking along the residential road with level surface. The pavement to the entrance door is slightly ramped.
- The apartment will be available from 4.30pm on your day of arrival.
- The key to the property is kept in a key safe, adjacent to the entrance door, 130cm from floor level. The key can be picked up from the St Davids Escapes office, by prior arrangement, if required.
- WiFi is provided within the cottage.
- Mobile reception can be poor in and around St Davids. Please check with your provider, prior to arrival.

First Floor Plan

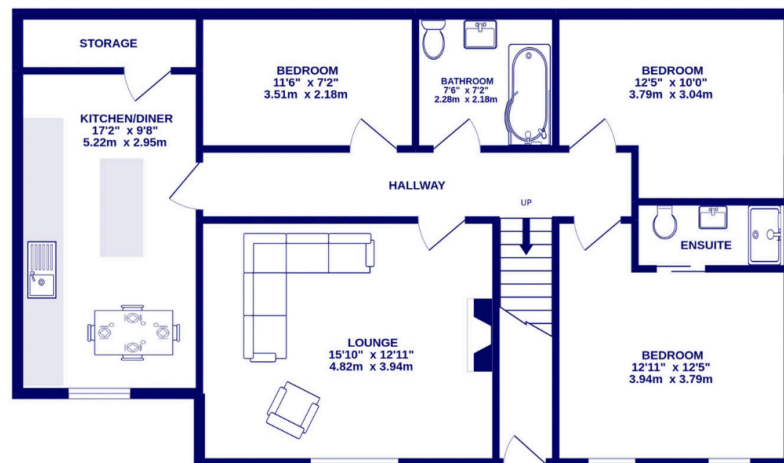

Entrance to Property & Entrance Hall

- There is one step to the front door which is 25cm high and 90cm wide.
- The front door is 77cm wide and hinged on the right side. The keyhole is 95cm high.
- The entrance is lit by a street lighting.
- The floor covering inside the entrance is a short pile carpet with door mat.
- The hall is 128cm wide and has a low level bench reducing the stair width.
- There is good colour contrast between floors, walls and doors.

Stairs & Landing

- The stairs have a low level of light, illuminated by a ceiling pendant.
- There are 13 steps (20cm high, 25cm deep, 85cm wide) with a handrail on the left side, 78cm high from the stair tread.
- The landing is 97cm wide.
- The floor covering is a short pile carpet.
- The walls colour is dark in tone.
- Audible smoke alarm fitted.

Lounge

- The lounge is situated on the first floor with level entry from the hall.
- The door opening width between the hall and lounge is 75cm.
- The room has two sofas with non-feather cushion seating.
- There is a Smart TV with remote control providing subtitles and audio description capability.
- Natural daylight enters through the large front bay window and two velux ceiling windows.
- The wall colours are dark in tone.
- There is a ceiling pendant light, floor lamp and table lamps.
- There is an electric fire operated by a remote control.
- The floor is carpeted with a medium height pile.
- There is good colour contrast between floors, walls and doors.
- Audible smoke alarm fitted.

Kitchen & Dining Area

- The kitchen and dining area are situated on the first floor with level access from the hall.
- The door opening width between the hall and kitchen is 75cm.
- The oven is 140cm from the floor. The door of the oven drops down and the handle is 125cm above the floor. The hob is 95cm from the floor.
- The worktop and sink with mixer lever taps are 87cm above the floor. The microwave is on the worktop, with a cordless kettle and toaster.
- The fridge is undercounter with the highest shelf at 62cm and the lowest drawer at 24cm.
- The dining area is within the kitchen. There is a dining table (76cm high) with four loose chairs (45cm seat height) and a bench seat (49cm seat height).
- There is a kitchen bar unit with three high stools (67cm seat height).
- Glasses can be moved from the wall cupboards if required. Please request this when booking.
- Natural daylight enters through the side windows and ceiling velux window.
- The wall colours are dark in tone.
- There are ceiling pendant lights and downlights.



- There is a wooden floor.
- There is a good colour contrast between floor, cupboards and other surfaces.
- Audible heat alarm fitted.
- There is a fire blanket located in the eaves store cupboard.

Bathroom

- The bathroom is situated on the first floor with level access from the landing.
- The door opening width between the landing and bathroom is 75cm.
- The toilet seat height is 40 cm high and is only accessible from the front.
- The wash basin is wall mounted within a vanity and 86cm high (space under 32cm).
- The bath is 56cm high with a thermostatically controlled shower in a clear glass fixed screen.
- There are lever taps on both wash basin and bath.
- There are no grab rails or balance aids in the bath.
- The floor covering is tiled.
- The fixtures are all white (except the vanity) contrasting with the dark wall tile.
- There is a heated towel rail, 57cm high to the lowest rail and 147cm high to the highest.
- Natural daylight enters through the velux window.
- There are ceiling downlights.

Bedroom 1 - Kingsize Bedroom with En-suite Shower Room

- The door opening width between the bedroom and landing is 75cm.
- The height of the kingsize bed from the top of the mattress to the floor is 55cm and the clear space around the bed is 76cm.
- Non-feather duvets and pillows are provided.
- The chest of drawers is 83cm high and the bedside tables are 52cm high.
- There is a built-in wardrobe with door handles at 100cm high and hanging rail at 182cm high.
- Natural daylight enters through the two windows.
- The wall colours are dark in tone.
- There is a ceiling pendant light and table lamps.
- The floor covering is a short pile carpet.
- The opening width between the bedroom and en-suite is 63cm.
- The toilet seat height is 42 cm high and is only accessible from the front.
- The vanity wash basin is wall mounted and 84cm high.
- There is a thermostatically controlled shower in glass cubicle with sliding doors. The tray is 7cm.
- There are lever taps on the wash basin.
- There are no grab rails in the shower.
- The floor covering is tiled.
- The fixtures are all white and contrast with the wall and floor colours and finishes.
- There is a heated towel rail, 39cm high to the lowest rail and 132cm high to the highest.
- Natural daylight enters through the velux windows and two front windows.
- There is a ceiling pendant and table lamps.



Bedroom 2 - Kingsize Bedroom

- The door opening width between the bedroom and landing is 75cm.
- The height of the kingsize bed from the top of the mattress to the floor is 66cm and the clear space around the bed is 54cm.
- Non-feather duvets and pillows are provided.
- The chest of drawers is 135cm high and the bedside tables are 44cm high.
- There is a hanging rail on the door rear, at 176cm high.
- Natural daylight enters through the window.
- The wall colours are dark in tone.
- There is a ceiling pendant light and table lamps.
- The floor covering is a short pile carpet.

Bedroom 3 - Single Bedroom

- The door opening width between the bedroom and landing is 75cm.
- The room is located within the eaves with restricted ceiling height over the bed.
- The height of the single bed from the top of the mattress to the floor is 53cm and the clear space next to the bed is 112cm.
- Non-feather duvets and pillows are provided.
- The chest of drawers is 98cm high and the bedside tables are 45cm high.
- There is a hanging rail on the door rear at 176cm high.
- Natural daylight enters through the velux window .
- The wall colours are dark in tone.
- There is a ceiling pendant light and table lamps.
- The flooring covering is a short pile carpet.

Additional Information

- The information folder in the apartment is produced in size 12 font.
- Emergency procedures and contacts are provided in the 'Touch Stay' app.
- The nearest doctor surgery and hospital information are provided in the 'Touch Stay' app.
- The apartment is no smoking throughout.
- Mobility scooters are available to hire in advance from Oriel y Parc in St Davids to explore the city. Telephone 01437 720392
- Explore West Wales accessible attractions <https://www.visitwales.com/destinations/west-wales/access-all-areas-west-wales>



Property Photographs



Entrance Door



Stair to First Floor



Hallway



Kitchen & Dining



Kitchen & Dining



Dining Table



Lounge



En-suite Bedroom



Bedroom



Single Bedroom



Bathroom



En-suite Shower Room

